

## Aluminium earth cable and accessory



MICHAUD Exclusivity  
Antifraud solution



Ground cutting blade  
aluminium with box  
**N106**



Earth distributor 6 taps  
**Q979**

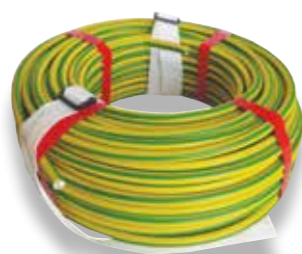

Aluminium earth cable  
**Q984 - Q985 - Q986**

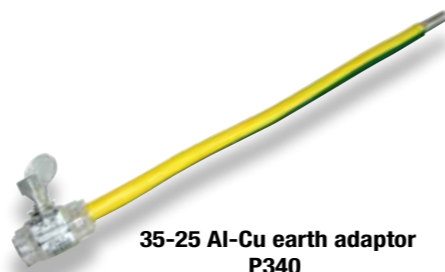

35-25 Al-Cu earth adaptor  
**P340**

### Application

The earth distributor is used to connect floor earths between themselves. It is installed in a building pillar according to applicable specifications. The ground cutting blade is installed at the bottom of the earth pillar. It enables the earth system opening during an earth resistance measurement.

### Benefits:

- + Aluminum terminals admitting copper or aluminium cable
- + Reversible box cover protecting the ground cutting blade
- + Earth distributor designed for an esthetic installation in 60x60mm conduit in case of renovation

### Description

- The earth distributor can receive:
  - 1 cable **50mm<sup>2</sup>** maximum without cutting (main line)
  - 6 possible taps 35mm<sup>2</sup> maximum
- It comprises an aluminium profile with shear head screws and insulation piercing and a box in synthetic materials giving it a protection degree type IPXXB.
- It is equipped with a handle offering a possible sealing.
- The ground cutting blade with box is equipped with:
  - An insulation piercing superior terminal block in tinned aluminium with shear head screws (no need of stripping)
  - A copper blade
  - An inferior terminal block in brass
  - A synthetic materials box with reversible opening and closing way, giving it a protection degree type IP44D
- It can receive **aluminium cable section from 25 up to 50mm<sup>2</sup>** and **copper cable section from 16 up to 35mm<sup>2</sup>**.
- The distribution board adaptor Al/Cu comprises:
  - A flexible tail 25mm<sup>2</sup>, length 230mm
  - A shear head screw
- It can receive cable sections from 25 up to 35mm<sup>2</sup>
- Its use is requested for the connection of the individual protection connector and the earth terminal block of the distribution board, when this one cannot receive aluminium.
- The earth cable FR-N-07V-AR is made of aluminium. It is delivered in ring with 2 straps making transportation easier and a box of 25 identification labels marked "Alu".
- It is available in 3 sections: 25, 35, 50mm<sup>2</sup>.
- It meets the requirements of **NF C32-208**.

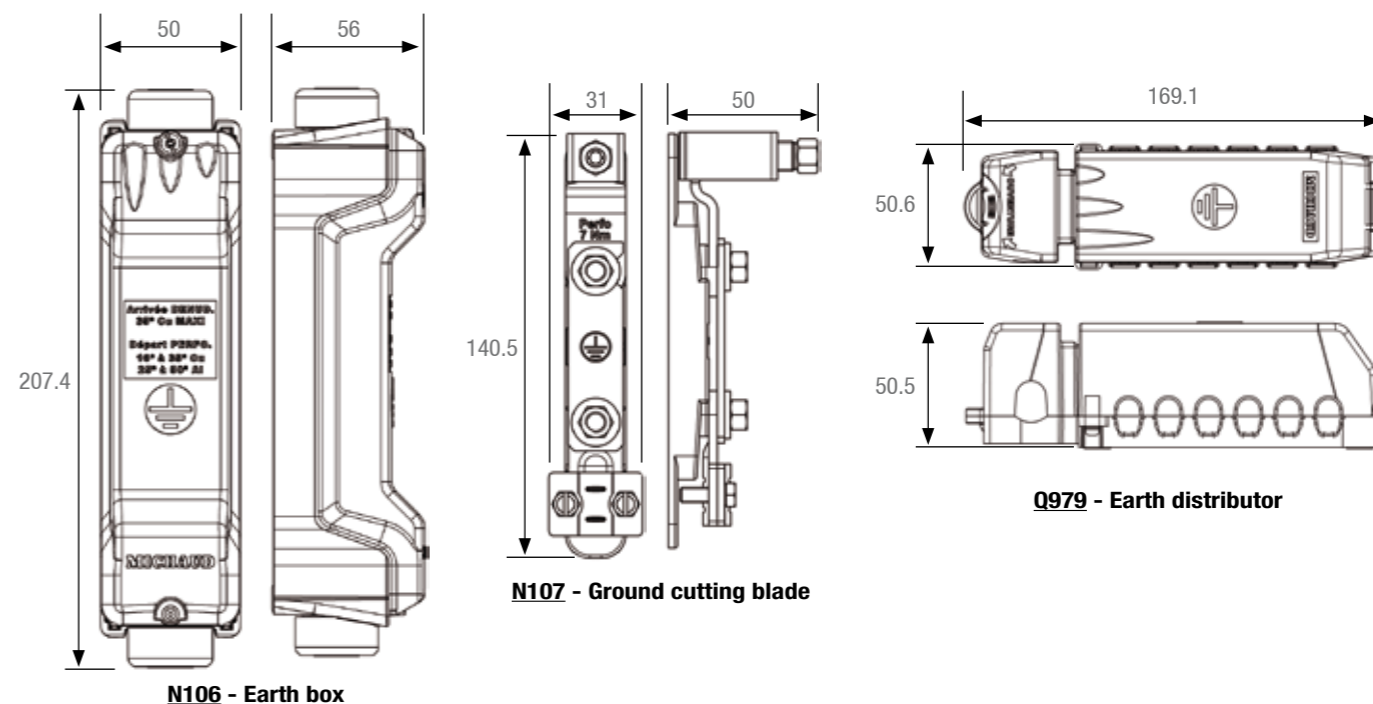

Code	Designation	Sales unit
N106	GROUND CUTTING BLADE ALUMINIUM WITH BOX	1
N107	GROUND CUTTING BLADE BARE AL	1
Q979	EARTH DISTRIBUTOR AL 6 TAPS	1
Q984	ALUMINIUM EARTH CABLE 25 <sup>2</sup> 100M	1
Q985	ALUMINIUM EARTH CABLE 35 <sup>2</sup> 100M	1
Q986	ALUMINIUM EARTH CABLE 50 <sup>2</sup> 50M	1
P340	AL/CU EARTH ADAPTOR 35-25	10

### Variants: Stripping technology

These products using the stripping technology require a brushing with neutral grease during installation.



Code	Designation	Sales unit
ED001	EARTH DISTRIBUTOR STRIP AL 5 TAPS	1
ED002	EARTH DISTRIBUTOR STRIP AL 8 TAPS	1
ED003	GROUND CUTTING BLADE AL STRIP	1

### Accessories

Code	Designation	Sales unit
<b>BOX FOR CUTTING BLADE ALONE</b> The box can be sold alone to receive for example a ground cutting blade for copper, Ref U036		
N108	BOX FOR GROUND CUTTING BLADE	1
<b>LABELS AL CABLE</b> These labels enable to identify aluminium cable		
N109	BOX OF 25 LABELS AL CABLE	1

